

## Fixed casters, electrically conductive

### Item description/product images



### Description

#### Material:

Housing steel plate.

Wheels with thermoplastic rubber tread.

Wheel body polypropylene.

#### Version:

Housing press formed.

Wheels with plain bearings.

#### Note:

Wheel axle threaded. Fixed casters with mounting plate. Electrically conductive wheels, non-marking gray. The ohmic resistance of the wheel  $\leq 10^4 \Omega$ .

#### Application:

Electrically conductive wheels on swivel and fixed casters are used to protect against electrostatic discharge generated by transport equipment or the transported goods. Damage to sensitive goods and painful electrostatic shocks to the personal is so prevented.

#### Temperature range:

-20 °C to +60 °C.

### Drawings

fixed castor

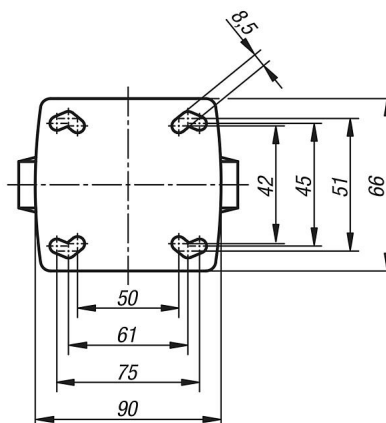
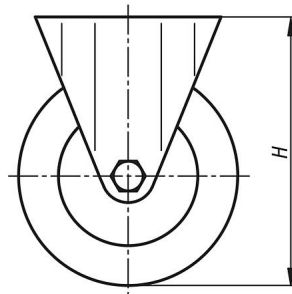

## Fixed casters, electrically conductive

### Drawings

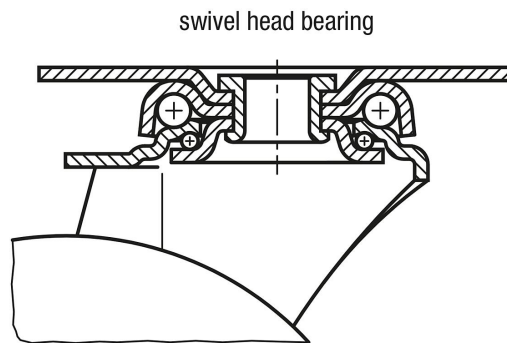

| Order No.      | Item         | Version 1              | Wheel bearing | B  | D   | H   | Permissible load kg |
|----------------|--------------|------------------------|---------------|----|-----|-----|---------------------|
| K1760.11080321 | Fixed caster | without locking system | plain bearing | 32 | 80  | 111 | 65                  |
| K1760.11100321 | Fixed caster | without locking system | plain bearing | 32 | 100 | 136 | 70                  |
| K1760.11125321 | Fixed caster | without locking system | plain bearing | 32 | 125 | 161 | 80                  |